

RESIDENTIAL ROUNDABOUT PLAN

62ND AVENUE NE AT NE 197TH STREET
N.T.S.

TRAFFIC CIRCLE NOTES:

1. PLACE YIELD LINES PER WSDOT STANDARD PLAN M-24.60-04, SHEET 2
2. PLACE ROUNDABOUT ARROWS PER WSDOT STANDARD PLAN M-24.50-00
3. FIELD VERIFY THE LOCATION OF R1-2 SIGN INSTALLATIONS WITH CITY ENGINEER
4. PLACE TEMPORARY "TRAFFIC REVISION AHEAD" SIGNS EITHER LEG FOR 4 WEEKS

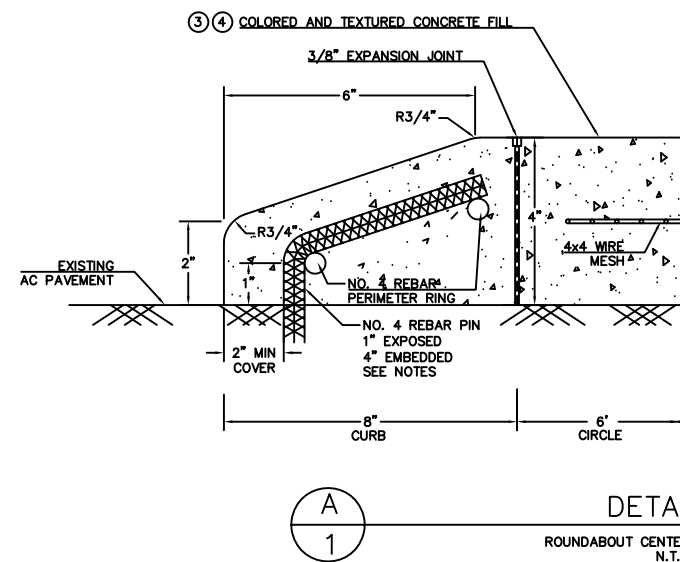

- NOTES:
1. RECOMMENDED CONSTRUCTION SEQUENCE:
 - A. DRILL REBAR DOWELS (PER DETAIL) AND BEND TOWARDS CENTER OF CIRCLE TO MATCH PROFILE OF CURB
 - B. PLACE PERIMETER RING BARS (PER DETAIL)
 - C. FORM CURB USING FIBER BOARD FORM WITH NAILED 2X4 STOPS ON INTERIOR AND EXTERIOR OF PERIMETER
 - D. PLACE CONCRETE TO CREATE CURB
 - E. USE 2" DOBBIES TO SUPPORT 4X4 WIRE MESH FOR CIRCLE CENTER PAD (4" THICKNESS)
 - F. TEXTURE AND COLOR CENTER CIRCLE PAD
 2. CONCRETE STRENGTH, MIN. 4000 PSI
 3. CIRCLE CONCRETE SHALL BE BRICK TEXTURED, "USED BRICK - BASKETWEAVE DOUBLE ROW" BY L.M. SCOFIELD COMPANY, TL-21020 4"X8" BASKETWEAVE USED BRICK BY BOMANITE CORPORATION OR ENGINEER APPROVED EQUAL
 4. CONCRETE COLORING SHALL BE BUTTERFIELD "STORM GRAY" PERMA-CAST SHAKE-ON COLOR HARDENER, OR ENGINEER APPROVED EQUAL

DETAIL A
ROUNDABOUT CENTER ISLAND SECTION
N.T.S.

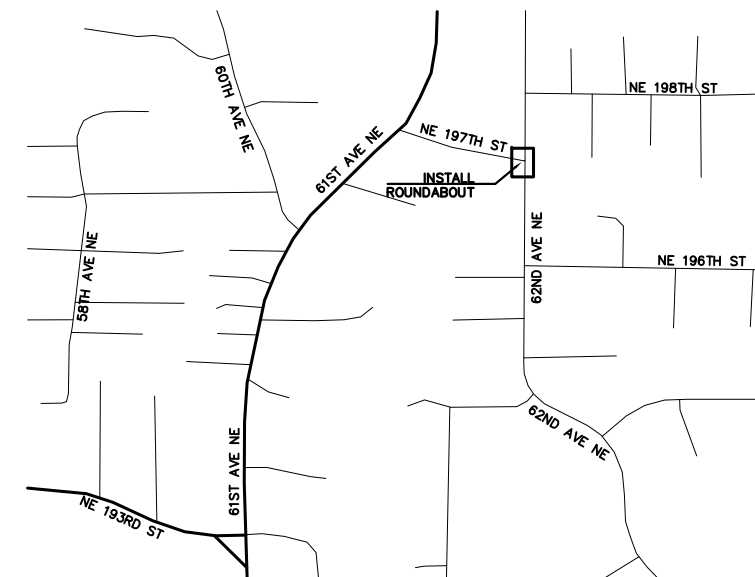

PROJECT LOCATION MAP - 62ND/197TH

PROJECT LOCATION MAP

| NO. | DATE | BY | REVISION |
|-----|------|----|----------|
| | | | |
| | | | |
| | | | |
| | | | |
| | | | |
| | | | |
| | | | |

Scale:
Horiz:
Vert:
Designed By:
BAS
Drawn By:
BAS
Reviewed By:
Date:
6/30/17



City of Kenmore
PUBLIC WORKS DEPARTMENT
18120 68th Ave NE - PO Box 82607, Kenmore WA 98028
425-398-8900 - www.kenmorewa.gov

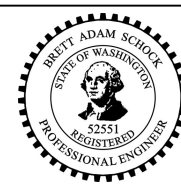

PROJECT #17-C1723

62ND AVENUE NE
AT NE 197TH STREET
RESIDENTIAL ROUNDABOUT

Sheet No.
1
4
Of Total