

CITY HALL ROOM RENTAL AMENITIES COMMUNITY MEETING ROOM AND CITY COUNCIL CHAMBERS

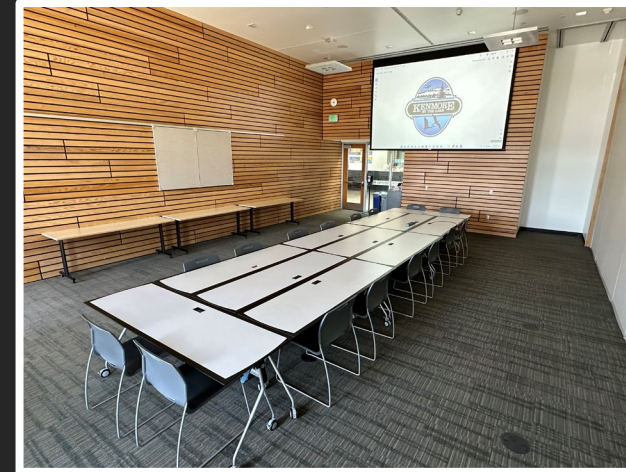

COMMUNITY MEETING ROOM AND CITY COUNCIL CHAMBERS FLOORPLAN DIAGRAM

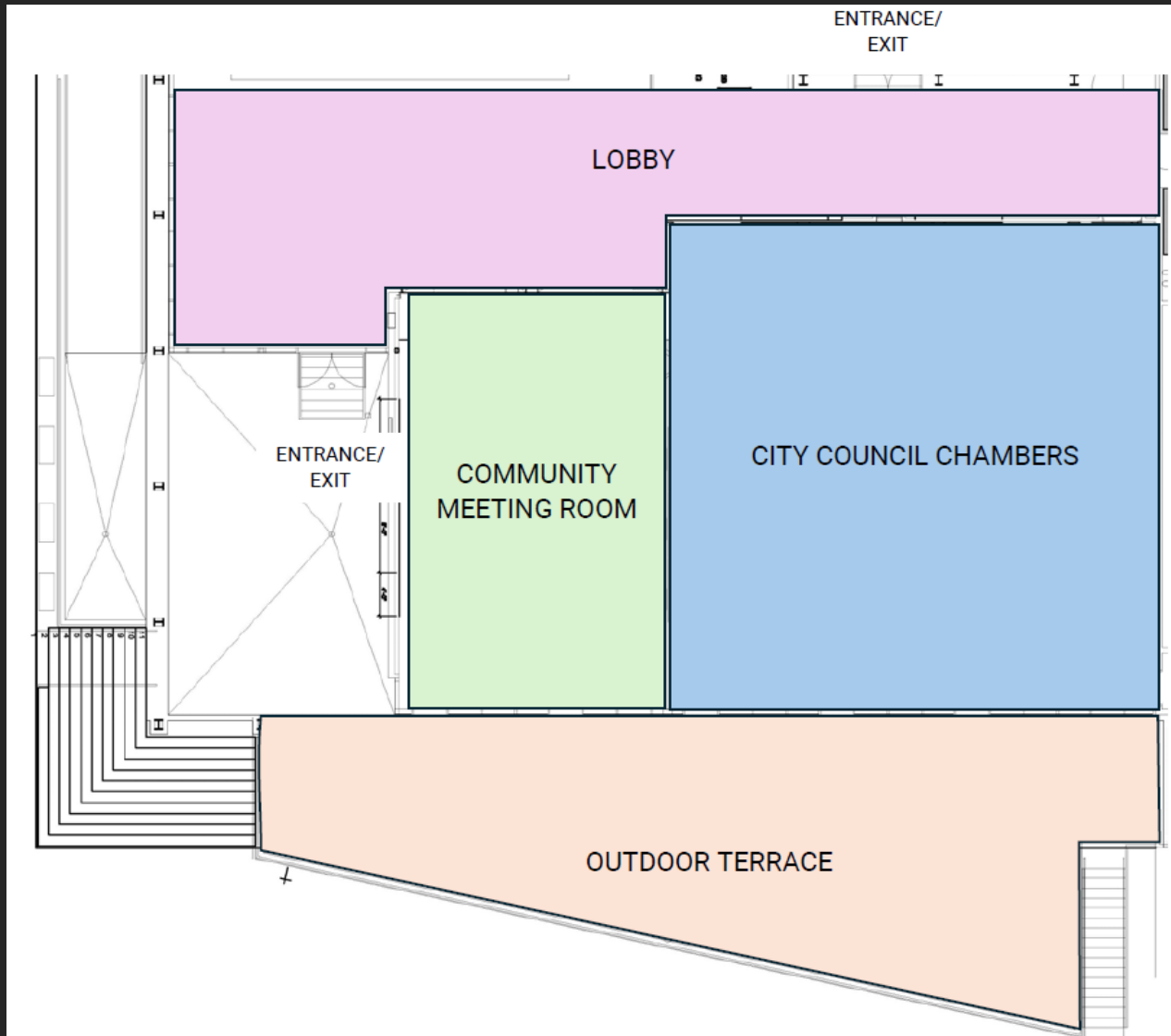

COMMUNITY MEETING ROOM
(SHOWN IN DEFAULT BOARDROOM LAYOUT)



CITY COUNCIL CHAMBERS
(SHOWN IN DEFAULT COUNCIL MEETING LAYOUT)

FURNITURE GUIDE – AVAILABLE FOR USE DURING RENTALS



STACKABLE CHAIRS
TOTAL AVAILABLE: 90

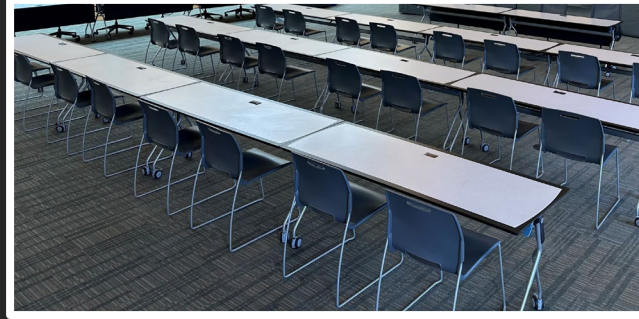

RECTANGULAR TASK TABLES
SIZE: 6 FT LONG x 2 FT WIDE
TOTAL AVAILABLE: 22

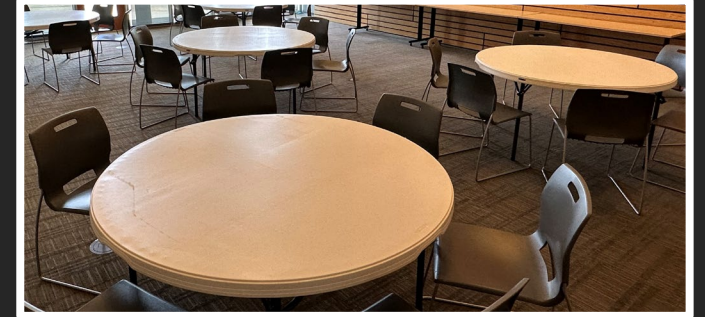

ROUND BANQUET TABLES
SIZE: 5 FT DIAMETER
TOTAL AVAILABLE: 15

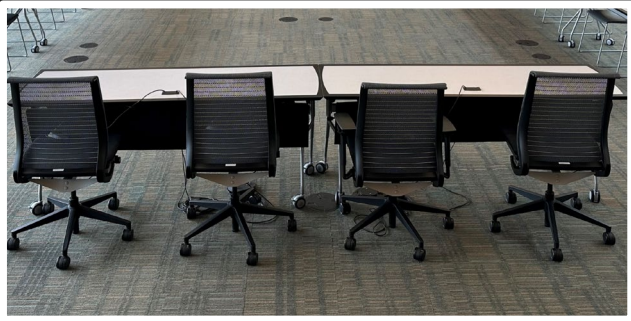

ROLLING OFFICE CHAIRS
TOTAL AVAILABLE: 10

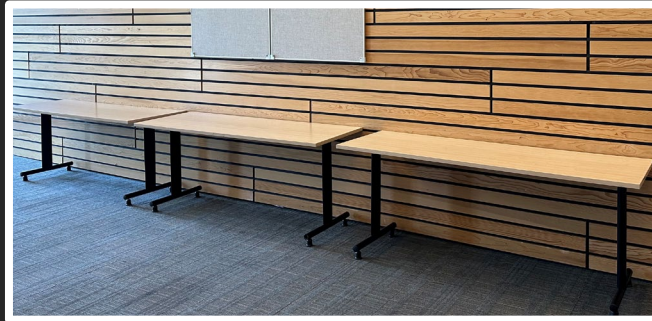

RECTANGULAR SIDE TABLES
TOTAL AVAILABLE: 3
(PERMANENT IN COMMUNITY MEETING ROOM)

FURNITURE AND COMPONENTS NOT AVAILABLE FOR PUBLIC USE



CITY COUNCIL DIAS
(LOCATED IN CITY COUNCIL CHAMBERS)

THE CITY COUNCIL DIAS AND THE CITY CLERK'S DESK ARE FIXED PIECES OF FURNITURE AND CANNOT BE MOVED. THEY ARE NOT AVAILABLE FOR USE AND WILL BE COVERED DURING ALL RENTALS.



PROJECTOR AND SCREEN
(LOCATED IN CITY COUNCIL CHAMBERS)

THE PROJECTOR AND SCREEN IN THE COUNCIL CHAMBERS IS ONLY AVAILABLE FOR USE BY OTHER GOVERNMENT AGENCIES. THE COMMUNITY ROOM PROJECTOR AND SCREEN IS AVAILABLE FOR USE DURING ALL RENTALS.

COMMUNITY MEETING ROOM

BOARDROOM LAYOUT
(DEFAULT ROOM LAYOUT)

SEATED CAPACITY AS SHOWN: 16*

ROOM IS PROVIDED WITH THIS SETUP

FURNITURE PROVIDED:

- 11 RECTAGULAR TASK TABLES
- 16 STACKABLE CHAIRS*
- 3 RECTANGULAR SIDE TABLES



*ADDITIONAL CHAIRS MAY BE AVAILABLE UPON REQUEST; HOWEVER, TABLE LEGS WILL INTERFERE WITH ANY ADDITIONAL CHAIRS PLACED IN THIS CONFIGURATION.

COMMUNITY MEETING ROOM

BANQUET LAYOUT

SEATED CAPACITY AS SHOWN: 30*

APPLICANT IS RESPONSIBLE FOR SETUP

FURNITURE PROVIDED:

- 5 ROUND BANQUET TABLES
- 30 STACKABLE CHAIRS*
- 3 RECTANGULAR SIDE TABLES



*ADDITIONAL CHAIRS MAY BE AVAILABLE UPON REQUEST; HOWEVER, IT IS NOT RECOMMENDED TO PLACE MORE THAN 7 CHAIRS AT EACH TABLE.

COMMUNITY MEETING ROOM

CLASSROOM LAYOUT

SEATED CAPACITY AS SHOWN: 18*

APPLICANT IS RESPONSIBLE FOR SETUP

FURNITURE PROVIDED:

- 11 RECTAGULAR TASK TABLES
- 22 STACKABLE CHAIRS*
- 3 RECTANGULAR SIDE TABLES



*ADDITIONAL CHAIRS MAY BE AVAILABLE UPON REQUEST; HOWEVER, TABLE LEGS WILL INTERFERE WITH ANY ADDITIONAL CHAIRS PLACED IN THIS CONFIGURATION.

COMMUNITY MEETING ROOM

THEATER LAYOUT

SEATED CAPACITY AS SHOWN: 28*

APPLICANT IS RESPONSIBLE FOR SETUP

FURNITURE PROVIDED:

- 2 RECTAGULAR TASK TABLES
- 30 STACKABLE CHAIRS*
- 3 RECTANGULAR SIDE TABLES



*ADDITIONAL CHAIRS MAY BE AVAILABLE UPON REQUEST.

CITY COUNCIL CHAMBERS

CITY COUNCIL MEETING LAYOUT (DEFAULT ROOM SETUP)

SEATED CAPACITY AS SHOWN: UP TO 60*

ROOM IS PROVIDED WITH THIS SETUP

FURNITURE PROVIDED:

- 60 STACKABLE CHAIRS*
- 10 ROLLING OFFICE CHAIRS
- 5 RECTANGULAR TASK TABLES
- 1 ROLLING WOODEN PODIUM

*ADDITIONAL CHAIRS MAY BE AVAILABLE UPON REQUEST.

PLEASE NOTE: THE CITY COUNCIL DIAS AND THE CITY CLERK'S DESK ARE FIXED PIECES OF FURNITURE AND CANNOT BE MOVED. THEY ARE NOT AVAILABLE FOR USE AND WILL BE COVERED DURING YOUR RENTAL. ADDITIONALLY, THE PROJECTOR AND SCREEN IN THE COUNCIL CHAMBERS ARE ONLY AVAILABLE FOR USE BY GOVERNMENT AGENCIES.



CITY COUNCIL CHAMBERS

CLASSROOM LAYOUT

SEATED CAPACITY AS SHOWN: 24*

APPLICANT IS RESPONSIBLE FOR SETUP

FURNITURE PROVIDED:

- 24 STACKABLE CHAIRS*
- 10 ROLLING OFFICE CHAIRS
- 17 RECTANGULAR TASK TABLES

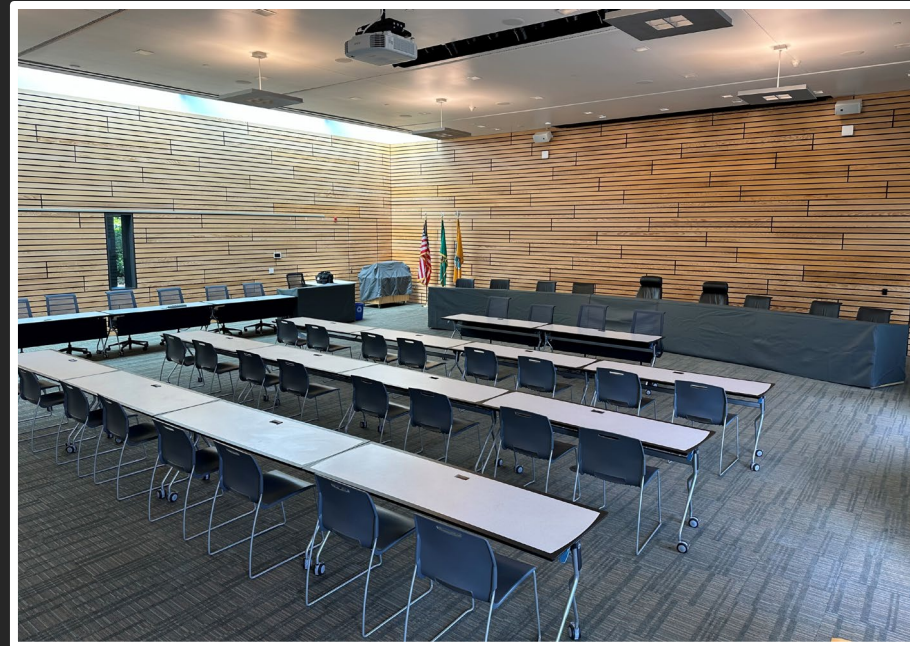

*ADDITIONAL CHAIRS MAY BE AVAILABLE UPON REQUEST; HOWEVER, TABLE LEGS WILL INTERFERE WITH ANY ADDITIONAL CHAIRS PLACED IN THIS CONFIGURATION.

PLEASE NOTE: THE CITY COUNCIL DIAS AND THE CITY CLERK'S DESK ARE FIXED PIECES OF FURNITURE AND CANNOT BE MOVED. THEY ARE NOT AVAILABLE FOR USE AND WILL BE COVERED DURING YOUR RENTAL. ADDITIONALLY, THE PROJECTOR AND SCREEN IN THE COUNCIL CHAMBERS ARE ONLY AVAILABLE FOR USE BY GOVERNMENT AGENCIES.

CITY COUNCIL CHAMBERS

U-SHAPE LAYOUT

SEATED CAPACITY AS SHOWN: 24*

APPLICANT IS RESPONSIBLE FOR SETUP

FURNITURE PROVIDED:

- 18 STACKABLE CHAIRS*
- 10 ROLLING OFFICE CHAIRS
- 14 RECTANGULAR TASK TABLES



*ADDITIONAL CHAIRS MAY BE AVAILABLE UPON REQUEST; HOWEVER, TABLE LEGS WILL INTERFERE WITH ANY ADDITIONAL CHAIRS PLACED IN THIS CONFIGURATION.

PLEASE NOTE: THE CITY COUNCIL DIAS AND THE CITY CLERK'S DESK ARE FIXED PIECES OF FURNITURE AND CANNOT BE MOVED. THEY ARE NOT AVAILABLE FOR USE AND WILL BE COVERED DURING YOUR RENTAL. ADDITIONALLY, THE PROJECTOR AND SCREEN IN THE COUNCIL CHAMBERS ARE ONLY AVAILABLE FOR USE BY GOVERNMENT AGENCIES.

CITY COUNCIL CHAMBERS & COMMUNITY MEETING ROOM COMBINED

BANQUET LAYOUT

SEATED CAPACITY AS SHOWN: 84*

APPLICANT IS RESPONSIBLE FOR SETUP

FURNITURE PROVIDED:

- 84 STACKABLE CHAIRS*
- 14 ROUND BANQUET TABLES
- 10 ROLLING OFFICE CHAIRS
- 5 RECTANGULAR TASK TABLES
- 3 RECTANGULAR SIDE TABLES

*6 ADDITIONAL CHAIRS ARE AVAILABLE UPON REQUEST FOR A TOTAL OF 90 SEATS MAXIMUM.

PLEASE NOTE: THE CITY COUNCIL DIAS AND THE CITY CLERK'S DESK ARE FIXED PIECES OF FURNITURE AND CANNOT BE MOVED. THEY ARE NOT AVAILABLE FOR USE AND WILL BE COVERED DURING YOUR RENTAL. ADDITIONALLY, THE PROJECTOR AND SCREEN IN THE COUNCIL CHAMBERS ARE ONLY AVAILABLE FOR USE BY GOVERNMENT AGENCIES.



CITY COUNCIL CHAMBERS & COMMUNITY MEETING ROOM COMBINED

THEATER LAYOUT

SEATED CAPACITY AS SHOWN: 90*

APPLICANT IS RESPONSIBLE FOR SETUP

FURNITURE PROVIDED:

- 90 STACKABLE CHAIRS*
- 10 ROLLING OFFICE CHAIRS
- 5 RECTANGULAR TASK TABLES
- 3 RECTANGULAR SIDE TABLES

***THIS LAYOUT USES ALL AVAILABLE CHAIRS.**

PLEASE NOTE: THE CITY COUNCIL DIAS AND THE CITY CLERK'S DESK ARE FIXED PIECES OF FURNITURE AND CANNOT BE MOVED. THEY ARE NOT AVAILABLE FOR USE AND WILL BE COVERED DURING YOUR RENTAL. ADDITIONALLY, THE PROJECTOR AND SCREEN IN THE COUNCIL CHAMBERS ARE ONLY AVAILABLE FOR USE BY GOVERNMENT AGENCIES.

