

2023 Pavement Overlay and Sidewalk Repair Project

Schedule:

Construction Spring 2023

Project Location:

73rd Ave NE from NE 181st St to NE 192nd St and NE 169th st from Simonds Rd NE to the end of the public road at NE 170th St.

Project Description:

The 73rd Ave NE Overlay project will grind 2 inches of existing pavement on 73rd Ave NE between NE 181st St to NE 192nd St and overlay with hot mix asphalt. Six curb ramps will be replaced to bring them in compliance with the American with Disabilities Act (ADA). A new pedestrian crosswalk flasher will be installed at NE 169th St

Background:

A typical overlay project includes grinding down old asphalt and overlaying new asphalt on the selected street(s). Grind and overlay projects are typically completed on roadways with pavement condition ratings between 60 and 70. As part of any pavement overlay, crosswalks impacted by the project are required to include upgrades to the curb ramps to comply with the Americans with Disabilities Act (ADA).

Channelization:

In support of a multi modal network, this project will add bicycle lanes within the project limits on 73rd Ave NE. Adding these bike lanes will mean that some of the existing on-street parking will be removed. Proposed modifications within the project limits include:

- 10-foot wide travel lanes
- Eliminate all on-street parking along the east side of 73rd Ave NE
- Removal of the northbound right turn lane on 73rd Ave NE onto NE 192nd St
- They City will be installing new "bike lane buffer curbing" at some locations to test their effectiveness.
- Some parking removal on the west side of 73rd Ave NE

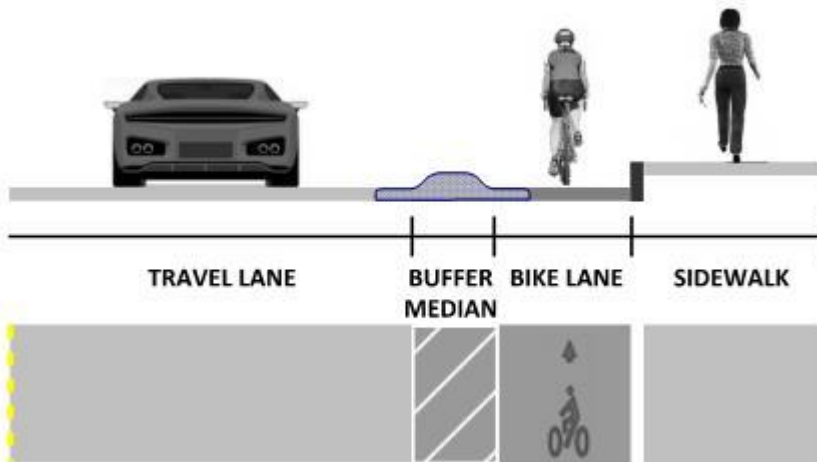

Sidewalk Repair - There are 46 sidewalk locations along 73rd Ave NE that are not compliant with the ADA. Some areas have uplifted panels in excess of 1/2 inch due to existing trees while other locations have either shifted over time or been damaged by trees that have since been removed. As many of these locations will be repaired as budget allows.

Tree Removal - There are many locations on 73rd Ave NE where trees are damaging the sidewalk. Some trees will be preserved bridging over the existing tree roots (see image below). However, several trees located in areas unsuitable for a tree will need to be removed.



The 169th St section of overlay does not have any tree removal or sidewalk repair.

ATTACHMENT A

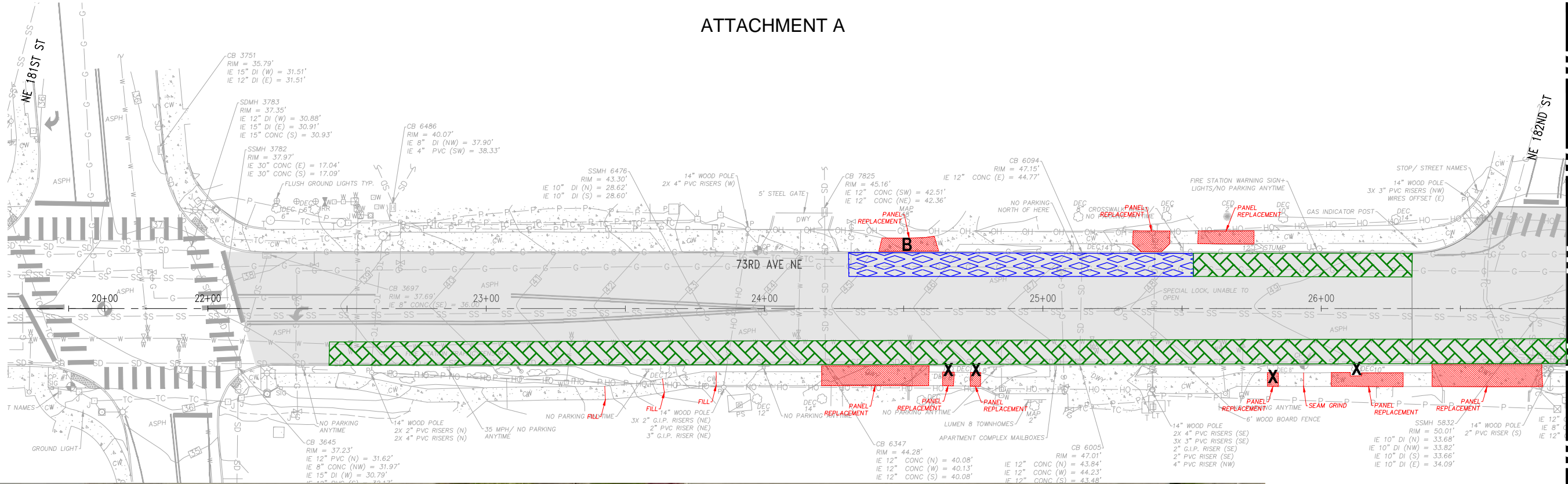

MATCHLINE: STA 15+25.00
SEE DWG PV02

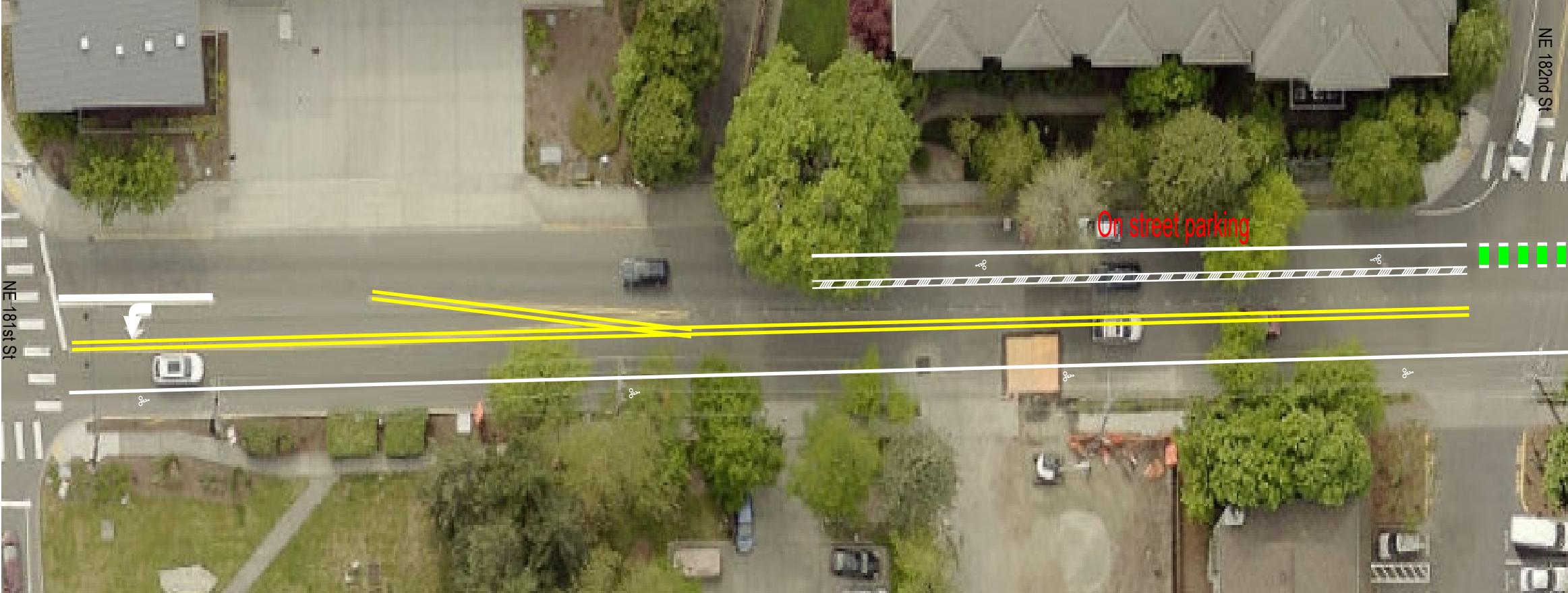

- EXISTING NO PARKING
- EXISTING PARKING TO REMAIN
- EXISTING PARKING TO BE REMOVED
- LIMITS OF OVERLAY
- SIDEWALK REPAIR LOCATIONS

- B** TREES PRESERVED IN PROPOSAL OPTION "B"
- C** SIDEWALK SECTIONS REPAIRED IN PROPOSAL OPTION "C"
- X** TREES PROPOSED TO BE REMOVED, ALL OPTIONS
- ?** NOT CERTAIN IF TREE CAN BE SAVED, NOT CLASSIFIED AS "SIGNIFICANT"

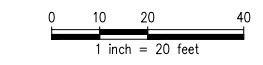

Name: WAnderson Date: Aug 04, 2021-08:01:13am File: C:\Temp\AcPublish_11960\73rd-Tree Replacement Locations.dwg

No	Date	Revision	By	Appr

CITY OF KENMORE
Public Works Department
18120 68th Ave NE
Kenmore, WA 98028
425-398-8900

DRAWN BY
XXX
CHECKED BY
XXX
DATE: 01/22/2020
J O B No. : 2000107

DESIGNED BY
XXX
APPROVED BY
XXX



1601 5th Avenue, Suite 1600
Seattle, WA 98101
206.622.5822
www.kpff.com

73RD AVE NE
OVERLAY AND PEDESTRIAN IMPROVEMENT PROJECT
30% PLAN DEVELOPMENT - PAVEMENT

SHEET X OF XX

01

SCALE: 1"=20'

ATTACHMENT A

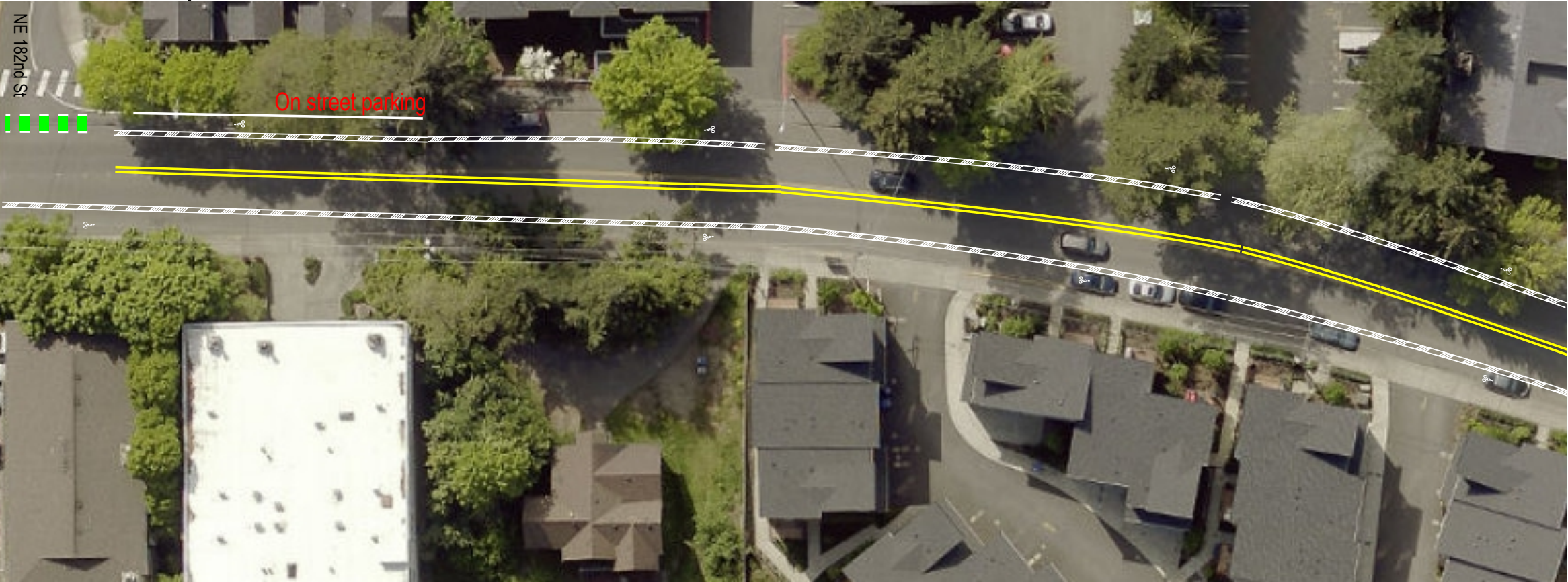
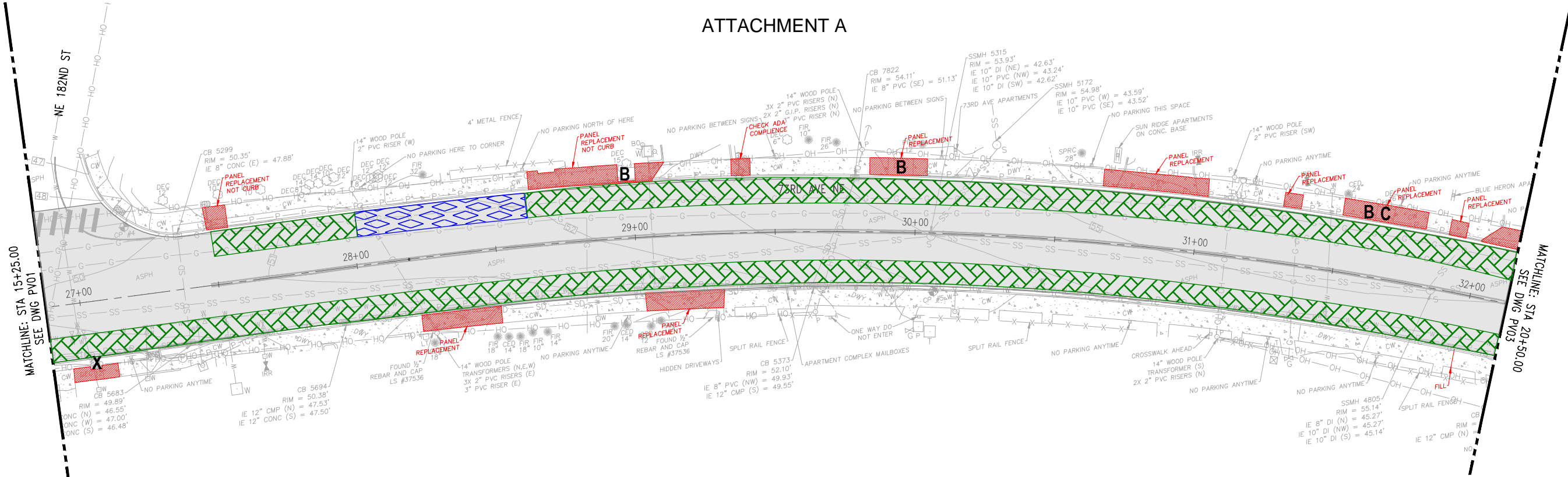

- EXISTING NO PARKING
- EXISTING PARKING TO REMAIN
- EXISTING PARKING TO BE REMOVED
- LIMITS OF OVERLAY
- SIDEWALK REPAIR LOCATIONS
- B TREES PRESERVED IN PROPOSAL OPTION "B"
- C SIDEWALK SECTIONS REPAIRED IN PROPOSAL OPTION "C"
- X TREES PROPOSED TO BE REMOVED, ALL OPTIONS
- ? NOT CERTAIN IF TREE CAN BE SAVED, NOT CLASSIFIED AS "SIGNIFICANT"

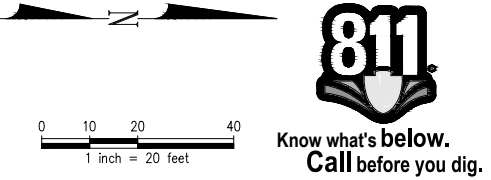

CITY OF KENMORE
Public Works Department
18120 68th Ave NE
Kenmore, WA 98028
425-398-8900

DRAWN BY
XXX
CHECKED BY
XXX
DATE: 01/22/2020
J O B No. : 2000107

DESIGNED BY
XXX
APPROVED BY
XXX

kpff
1601 5th Avenue, Suite 1600
Seattle, WA 98101
206.622.5822
www.kpff.com

73RD AVE NE
OVERLAY AND PEDESTRIAN IMPROVEMENT PROJECT
30% PLAN DEVELOPMENT - PAVEMENT

SHEET X OF XX

02

SCALE: 1"=20'

Name: Wanderson Date: Aug 04, 2021-08:01:15am File: C:\Temp\AcPublish_11960\73rd-Tree Replacement Locations.dwg

SW X/X SEC. XX, T. XX N., R. X E., W.M.

ATTACHMENT A

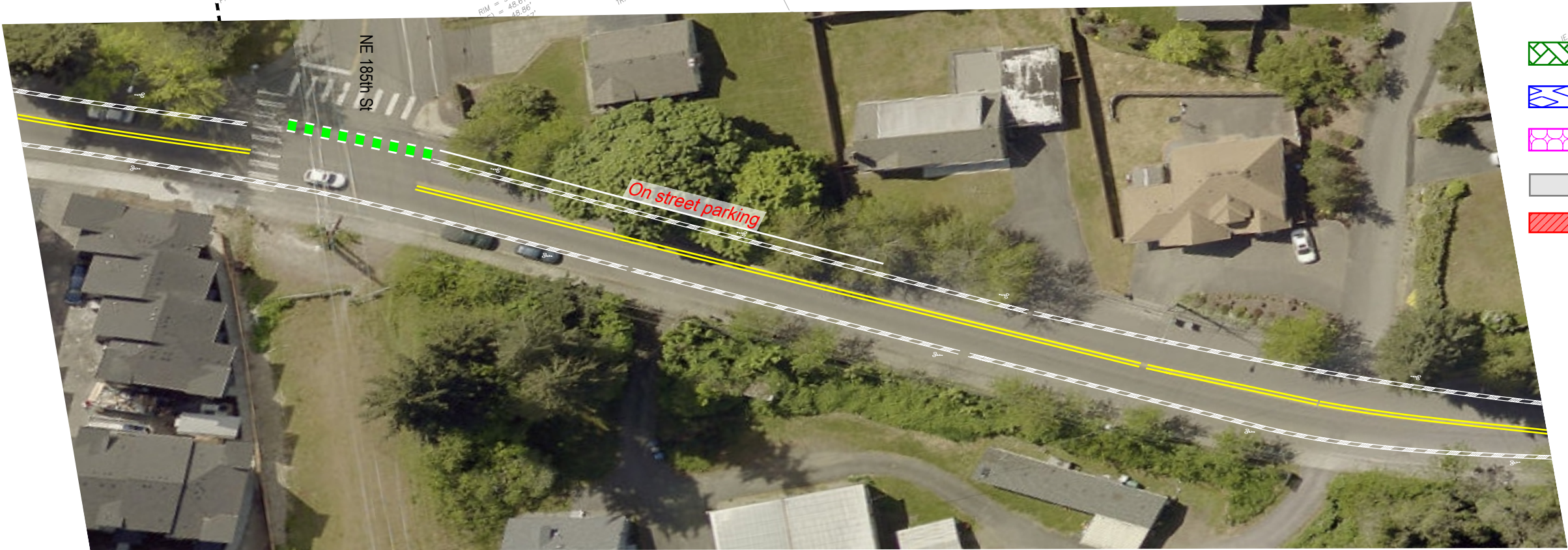
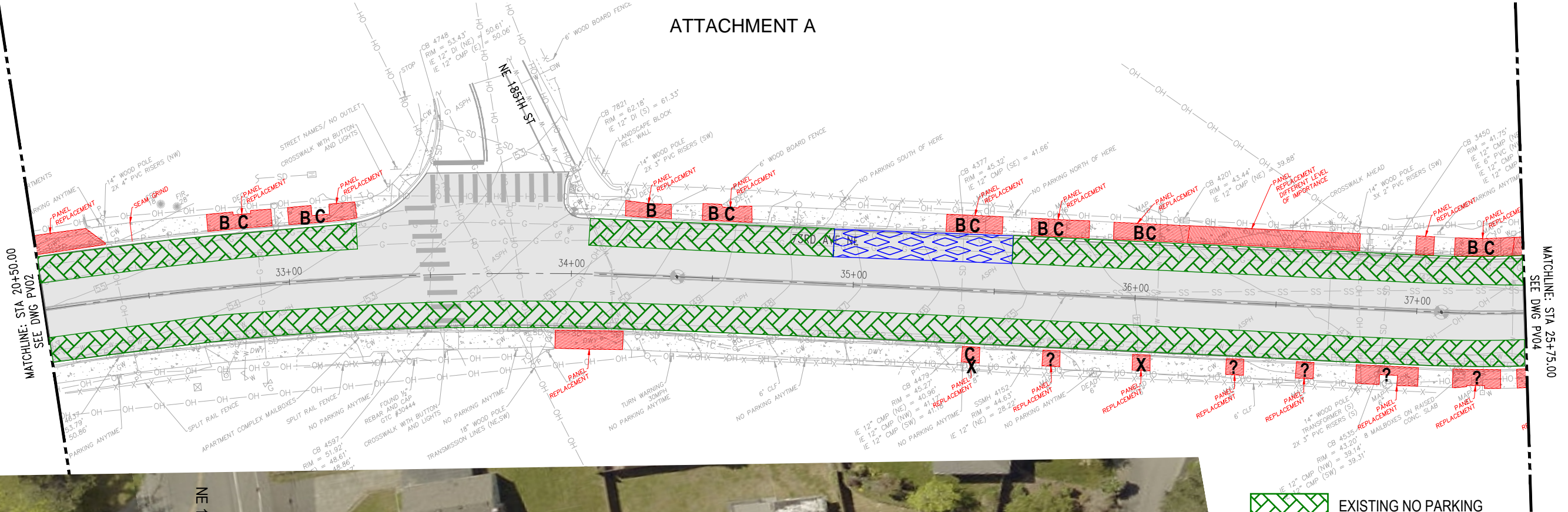

- EXISTING NO PARKING
- EXISTING PARKING TO REMAIN
- EXISTING PARKING TO BE REMOVED
- LIMITS OF OVERLAY
- SIDEWALK REPAIR LOCATIONS
- B** TREES PRESERVED IN PROPOSAL OPTION "B"
- C** SIDEWALK SECTIONS REPAIRED IN PROPOSAL OPTION "C"
- X** TREES PROPOSED TO BE REMOVED, ALL OPTIONS
- ?** NOT CERTAIN IF TREE CAN BE SAVED, NOT CLASSIFIED AS "SIGNIFICANT"

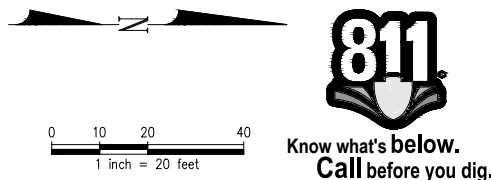

No	Date	Revision	By	Appr

CITY OF KENMORE
Public Works Department
18120 68th Ave NE
Kenmore, WA 98028
425-398-8900

DRAWN BY
XXX
CHECKED BY
XXX
DATE: 01/22/2020
J O B No. : 2000107

DESIGNED BY
XXX
APPROVED BY
XXX

kpff
1601 5th Avenue, Suite 1600
Seattle, WA 98101
206.622.5822
www.kpff.com

73RD AVE NE
OVERLAY AND PEDESTRIAN IMPROVEMENT PROJECT
30% PLAN DEVELOPMENT - PAVEMENT

SHEET X OF XX
03
SCALE: 1"=20'

SW X/X SEC. XX, T. XX N., R. X E., W.M.
ATTACHMENT A

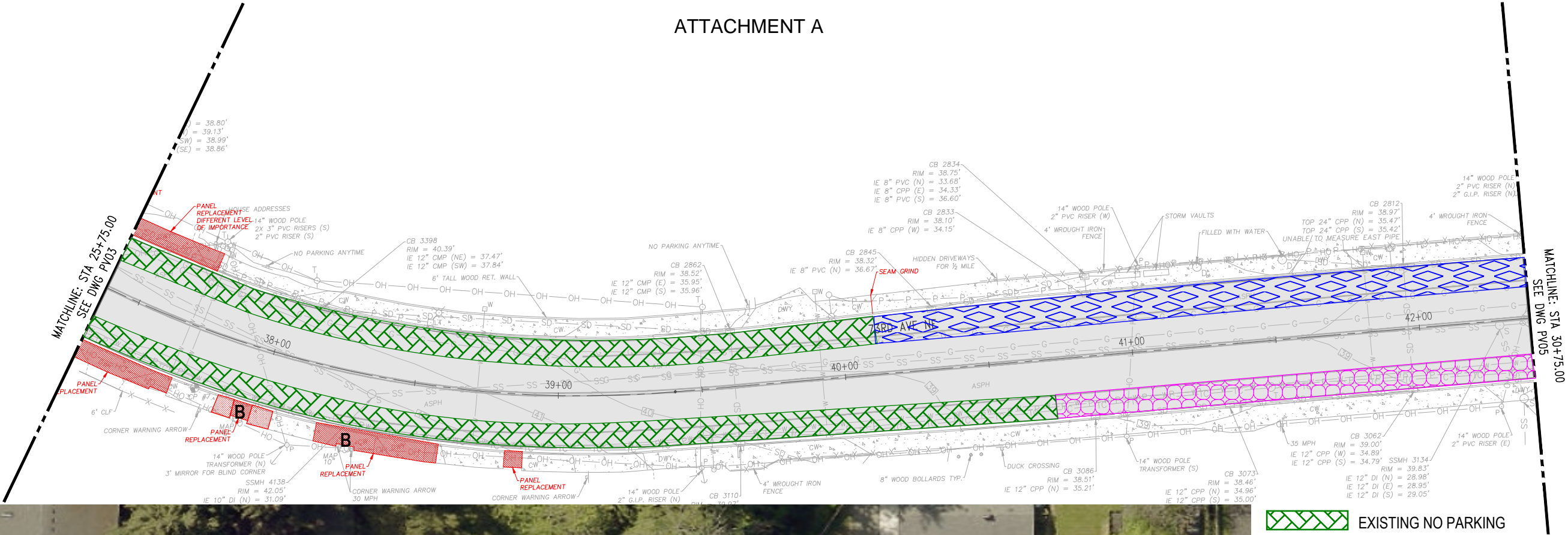

- EXISTING NO PARKING
- EXISTING PARKING TO REMAIN
- EXISTING PARKING TO BE REMOVED
- LIMITS OF OVERLAY
- SIDEWALK REPAIR LOCATIONS
- B TREES PRESERVED IN PROPOSAL OPTION "B"
- C SIDEWALK SECTIONS REPAIRED IN PROPOSAL OPTION "C"
- X TREES PROPOSED TO BE REMOVED, ALL OPTIONS
- ? NOT CERTAIN IF TREE CAN BE SAVED, NOT CLASSIFIED AS "SIGNIFICANT"

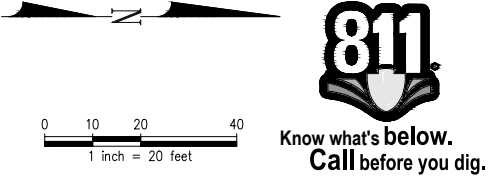

Name: WAnderson Date: Aug 04, 2021-08:01:15am File: C:\Temp\AcPublish_11960\73rd-Tree Replacement Locations.dwg

No	Date	Revision	By	Appr

CITY OF KENMORE
Public Works Department
18120 68th Ave NE
Kenmore, WA 98028
425-398-8900

DRAWN BY
XXX
CHECKED BY
XXX
DATE: 01/22/2020
J O B No. : 2000107

DESIGNED BY
XXX
APPROVED BY
XXX

kpff
1601 5th Avenue, Suite 1600
Seattle, WA 98101
206.622.5822
www.kpff.com

73RD AVE NE
OVERLAY AND PEDESTRIAN IMPROVEMENT PROJECT
30% PLAN DEVELOPMENT - PAVEMENT

SHEET X OF XX
04
SCALE: 1"=20'

Name: Wanderson Date: Aug 04, 2021-08:01:16am File: C:\Temp\AcPublish_11960\73rd-Tree Replacement Locations.dwg

SW X/X SEC. XX, T. XX N., R. X E., W.M.

ATTACHMENT A

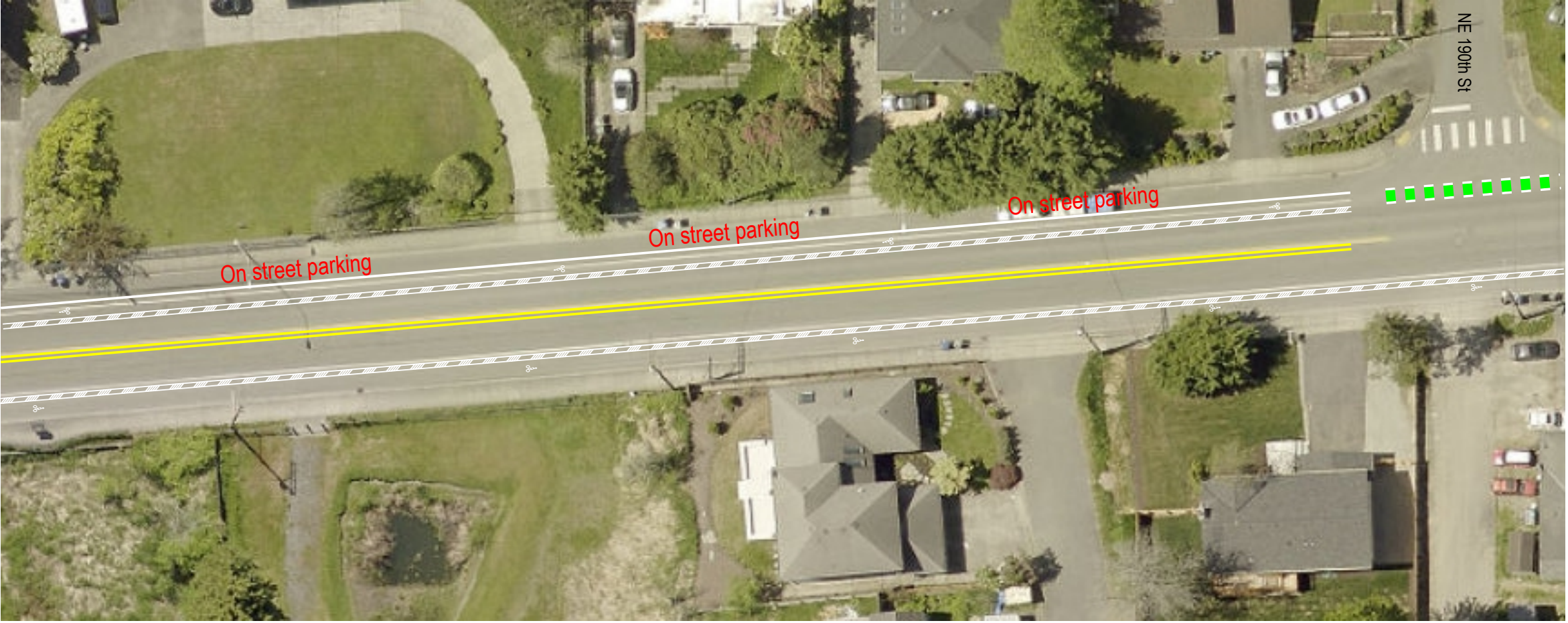
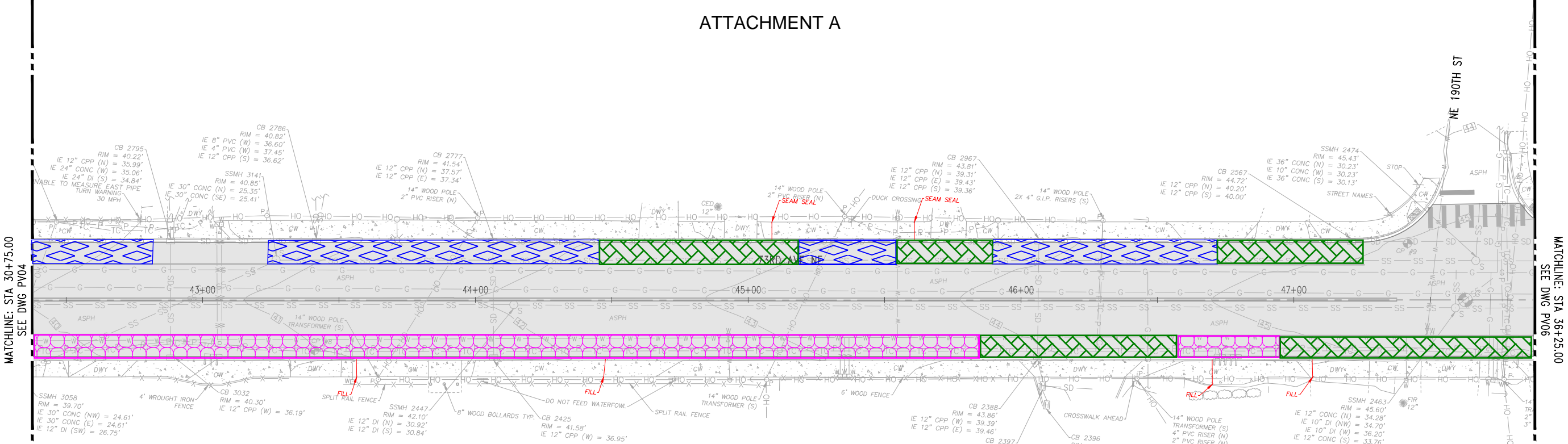

- LIMITS OF OVERLAY
- EXISTING NO PARKING
- EXISTING PARKING TO REMAIN
- EXISTING PARKING TO BE REMOVED

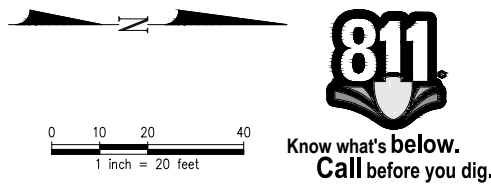

No	Date	Revision	By	Appr

CITY OF KENMORE
Public Works Department
18120 68th Ave NE
Kenmore, WA 98028
425-398-8900

DRAWN BY
XXX
CHECKED BY
XXX
DATE: 01/22/2020
J O B No. : 2000107

DESIGNED BY
XXX
APPROVED BY
XXX

kpff
1601 5th Avenue, Suite 1600
Seattle, WA 98101
206.622.5822
www.kpff.com

73RD AVE NE
OVERLAY AND PEDESTRIAN IMPROVEMENT PROJECT
30% PLAN DEVELOPMENT - PAVEMENT

SHEET X OF XX
05
SCALE: 1"=20'

Name: WAnderson Date: Aug 04, 2021-08:01:17am File: C:\Temp\AcPublish_11960\73rd-Tree Replacement Locations.dwg

SW X/X SEC. XX, T. XX N., R. X E., W.M.

ATTACHMENT A

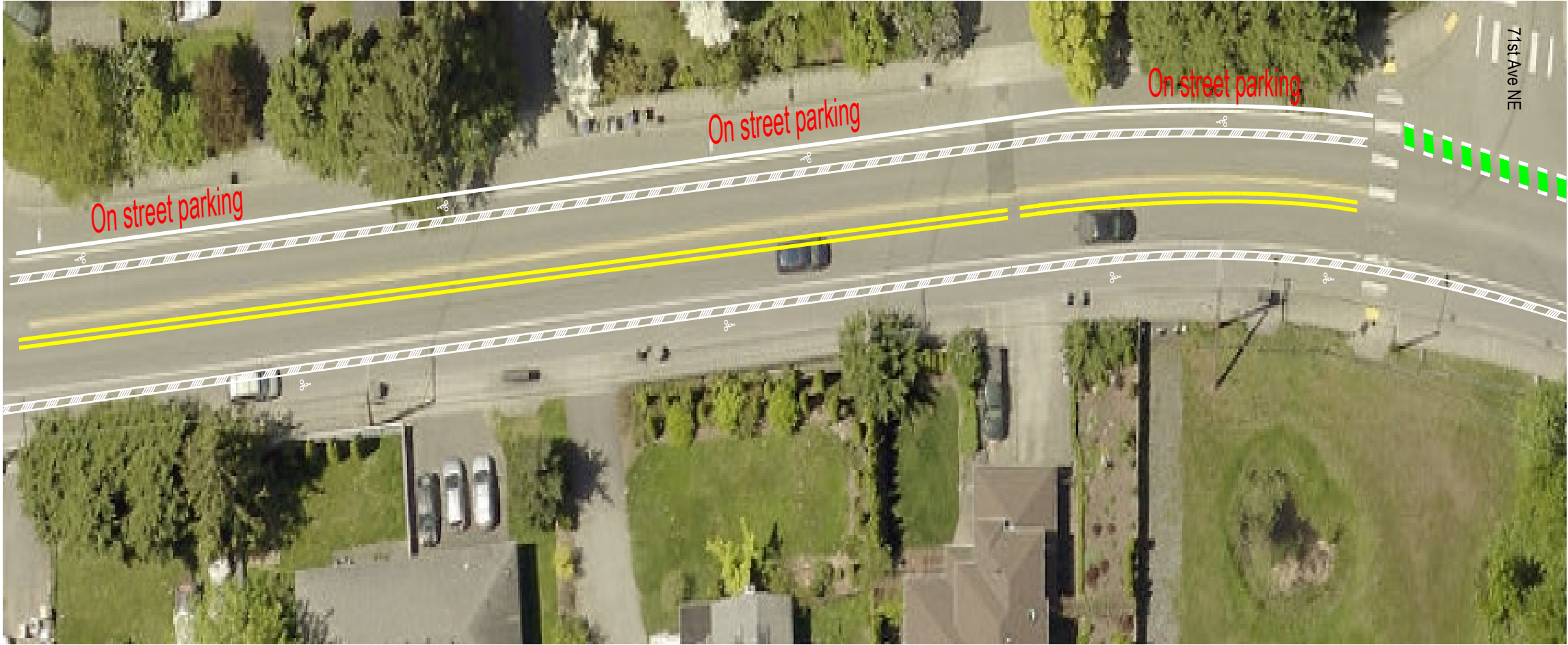
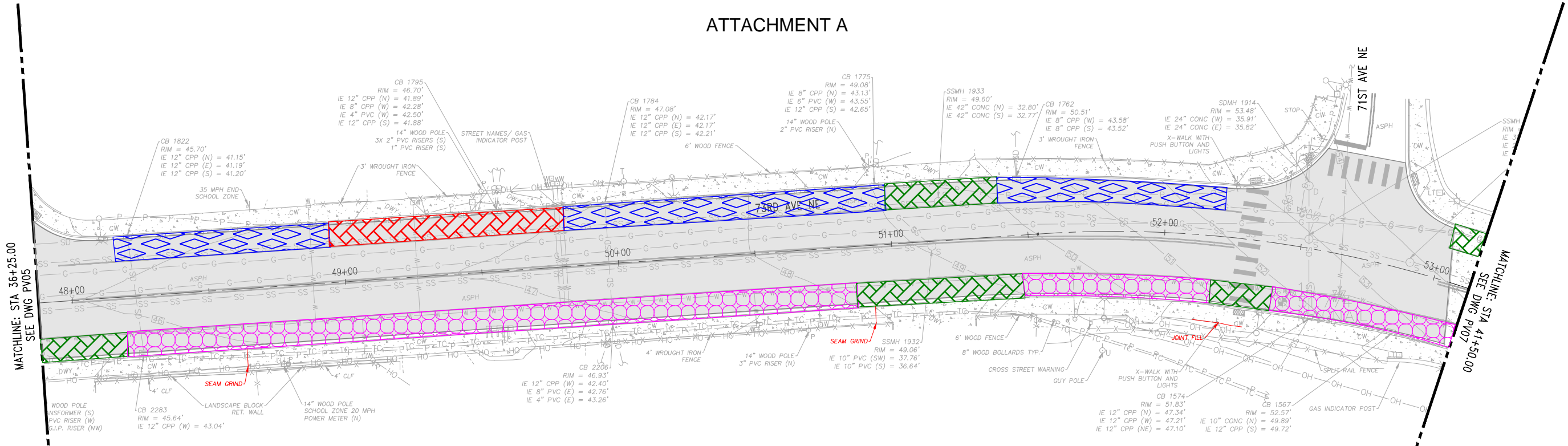

- LIMITS OF OVERLAY
- EXISTING NO PARKING
- EXISTING PARKING TO REMAIN
- EXISTING PARKING TO BE REMOVED

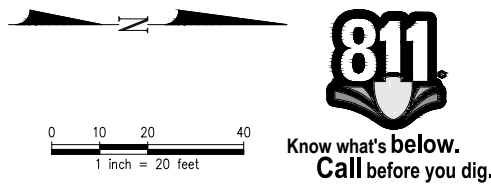

No	Date	Revision	By	Appr

CITY OF KENMORE
Public Works Department
18120 68th Ave NE
Kenmore, WA 98028
425-398-8900

DRAWN BY
XXX
CHECKED BY
XXX
DATE: 01/22/2020
J O B No. : 2000107

DESIGNED BY
XXX
APPROVED BY
XXX

kpff

1601 5th Avenue, Suite 1600
Seattle, WA 98101
206.622.5822
www.kpff.com

73RD AVE NE
OVERLAY AND PEDESTRIAN IMPROVEMENT PROJECT
30% PLAN DEVELOPMENT - PAVEMENT

SHEET X OF XX

06

SCALE: 1"=20'

ATTACHMENT A

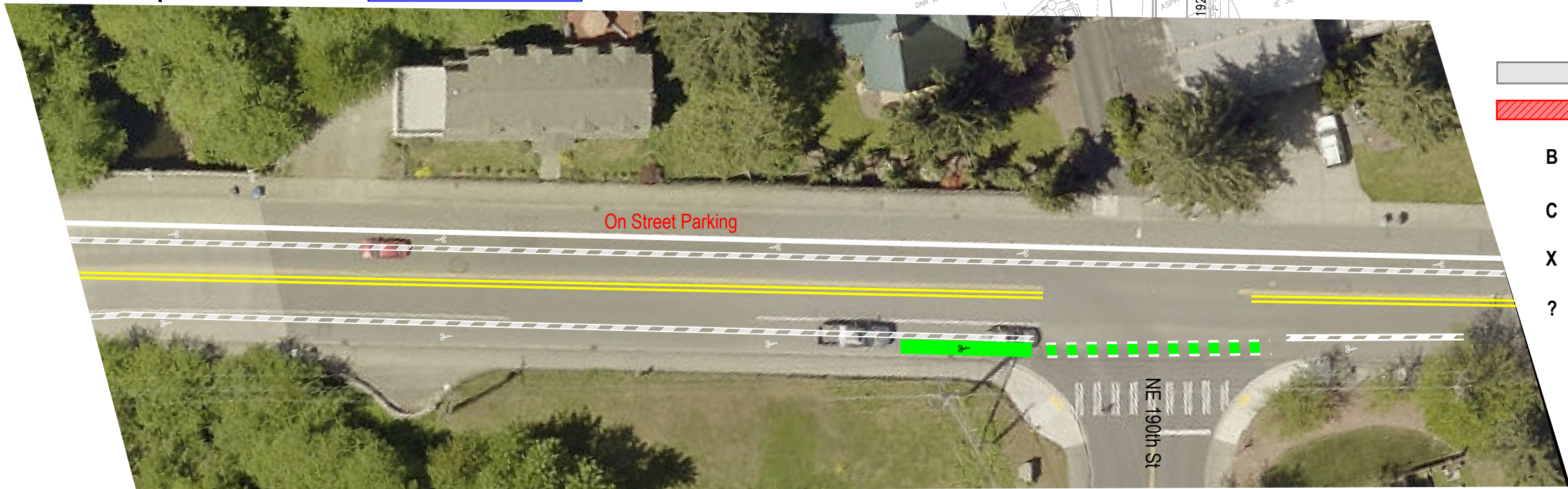
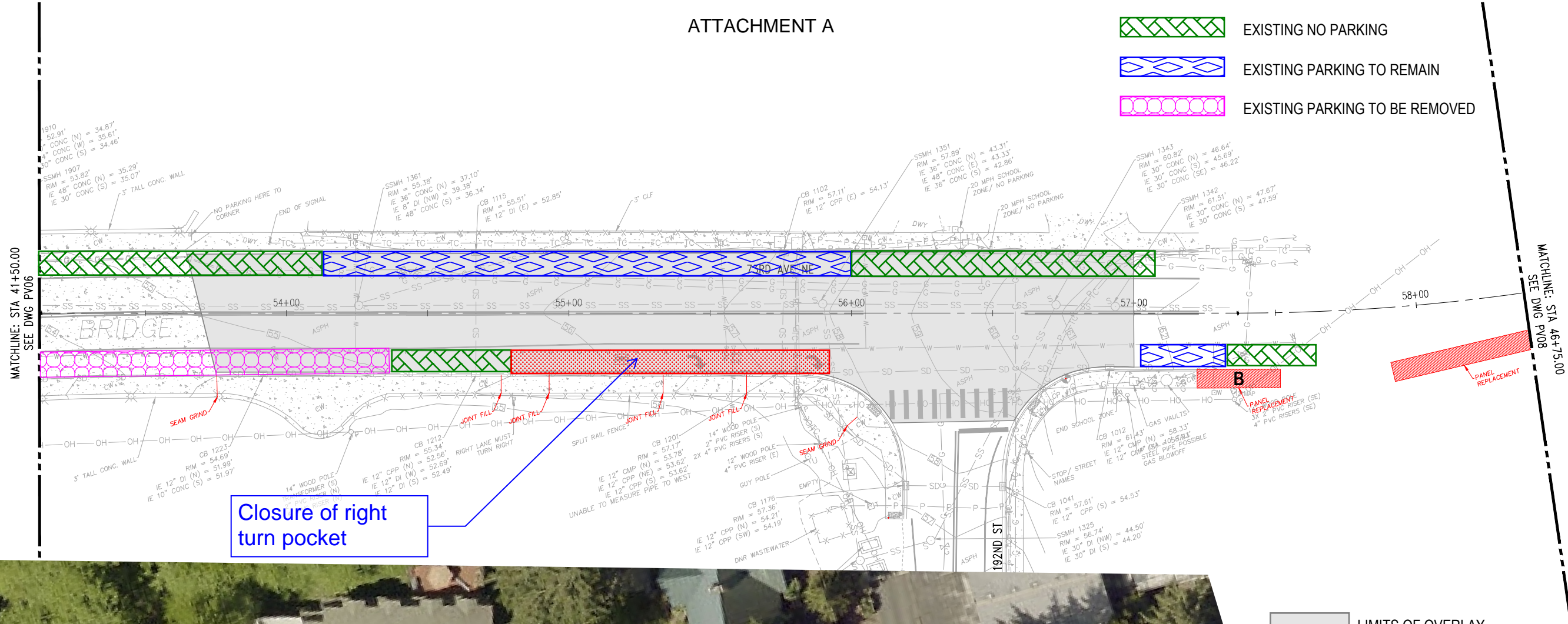

- LIMITS OF OVERLAY
- SIDEWALK REPAIR LOCATIONS
- B TREES PRESERVED IN PROPOSAL OPTION "B"
- C SIDEWALK SECTIONS REPAIRED IN PROPOSAL OPTION "C"
- X TREES PROPOSED TO BE REMOVED, ALL OPTIONS
- ? NOT CERTAIN IF TREE CAN BE SAVED, NOT CLASSIFIED AS "SIGNIFICANT"

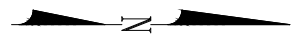

0 10 20 40
1 inch = 20 feet



CITY OF KENMORE
Public Works Department
18120 68th Ave NE
Kenmore, WA 98028
425-398-8900

DRAWN BY
XXX
CHECKED BY
XXX
DATE: 01/22/2020
J O B No. : 2000107

DESIGNED BY
XXX
APPROVED BY
XXX

kpff

1601 5th Avenue, Suite 1600
Seattle, WA 98101
206.622.5822
www.kpff.com

73RD AVE NE
OVERLAY AND PEDESTRIAN IMPROVEMENT PROJECT

30% PLAN DEVELOPMENT - PAVEMENT

SHEET X OF XX





07

SCALE: 1"=20'

73rd Avenue NE Pavement Overlay and Sidewalk Repair Project Map

From NE 181st Street to NE 185th Street

Key

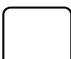
-  Permatrek elevated sidewalk
-  Tree removal, landscaping and restoration
-  Curb extensions
-  Parking removed
-  Bike lane

Visual References



PermaTrek elevated sidewalks to preserve trees.



Curb extensions for safer pedestrian crossing.

Visit the project website:
www.kenmorewa.gov/73rd



73rd Avenue NE Pavement Overlay and Sidewalk Repair Project Map

From NE 185th Street to NE 192nd Street

Key



Parking removed



Bike lane



Buffered bike lane with curbing

Visual Reference

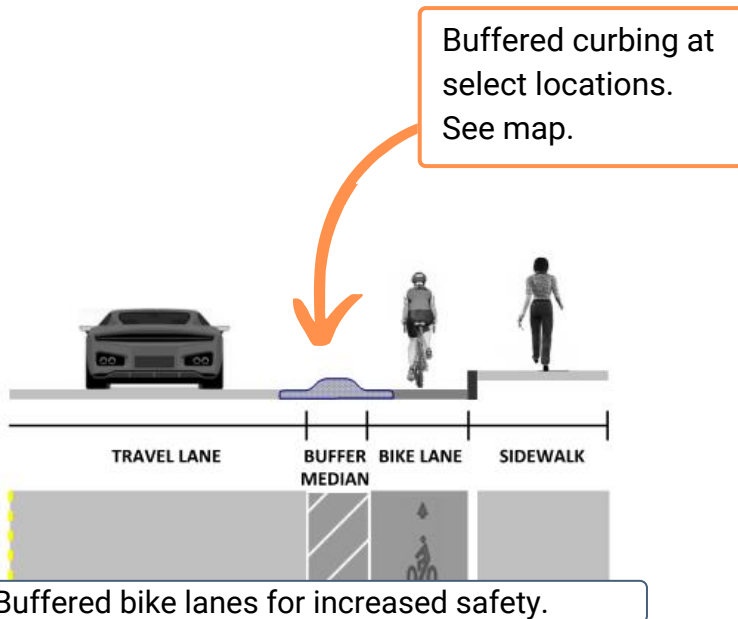

Visit the project website:
www.kenmorewa.gov/73rd

